

WINCHESTER ROAD & MIDLOTHIAN ROAD LAKE COUNTY DIVISION OF TRANSPORTATION



CHALLENGE

Reduce traffic congestion and long delays at a once-rural intersection.

Winchester Road and Midlothian Road, in Mundelein, is a busy intersection that has become very congested during morning and evening rush hours. Originally an intersection of two rural roads controlled by stop signs, land development and increased population has resulted in growth of traffic and the need to alleviate the daily delays and long lines of traffic.

The Lake County Division of Transportation called on HLR to develop a plan to improve traffic flow and traffic safety.

SOLUTION

HLR started with concept designs, including operational comparison of a roundabout and a regular signalized intersection, and Phase 1 Engineering analysis and design. The services included traffic flow and intersection traffic capacity analysis, geometric design of the intersection, stormwater management engineering analysis and design, and analysis of construction staging to keep the intersection open to traffic during construction.

To gain approval for the project, HLR coordinated with regulatory agencies including:

- IDOT for Federal funding and environmental resources review
- Lake County Stormwater Management Commission for stormwater drainage issues
- Illinois Department of Natural Resources for biological and natural resource issues

HLR also provided Phase II detailed engineering design for the project. Plans, specifications and estimates were provided including a detailed traffic management plan to keep traffic lanes open during construction.

Improvements designed include:

- Left-turn and right-turn lanes
- New traffic signals
- Improvement of stormwater drainage management
- Bicycle/pedestrian path along Midlothian Road
- Improvements to coordination between signal-controlled intersections

RESULTS

The construction contract for the project has been awarded and the project will be constructed in 2007.

Benefits of the proposed project will include:

- Enhanced traffic flow
- Reduced delays
- Improved traffic safety

**CONSTRUCTION BUDGET
\$1.8 MILLION**

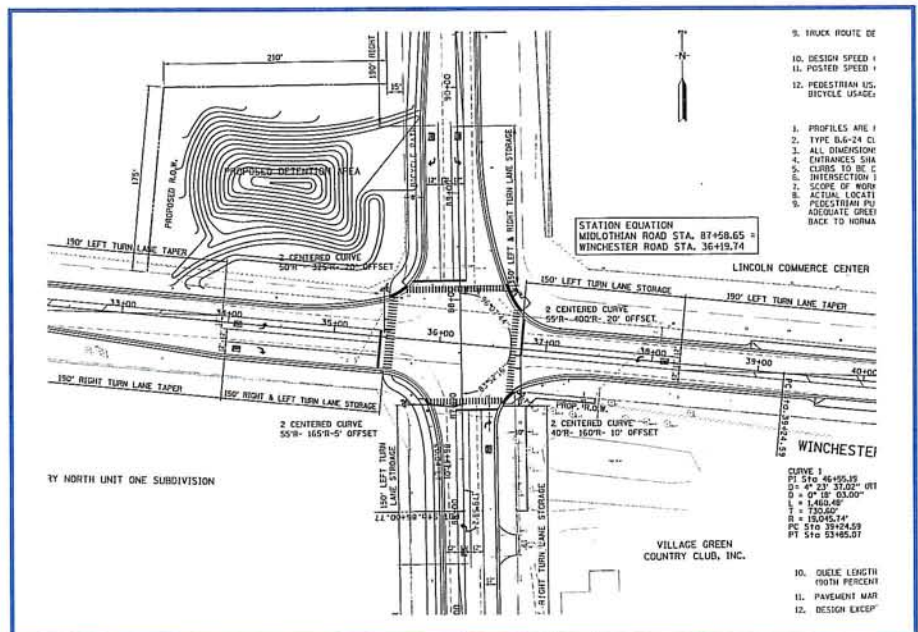

PLAN SHOWING PROPOSED INTERSECTION IMPROVEMENTS